

Quick Installation Guide

English | 繁體中文 | 簡體中文 | 日本語 | Français | Español | Deutsch | Português | Italiano | Türkçe | Polski | Русский | Český | Svenska | العربية

MD7530/7530D
MD7560/7560D

Vandal-proof · Mobile Surveillance

**Network
Camera**





Warning Before Installation

- Power off the Network Camera as soon as smoke or unusual odors are detected.



Contact your distributor in the event of occurrence.

- Refer to your user's manual for the operating temperature.

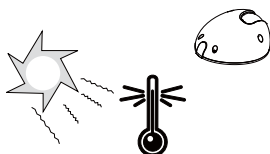

- Do not place the Network Camera on unsteady surfaces.

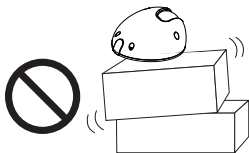

- Do not touch the Network Camera during a lightning storm.

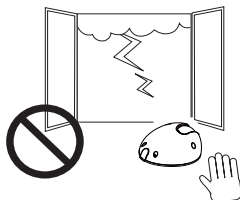

- Do not insert sharp or tiny objects into the Network Camera.



- Do not drop the Network Camera.

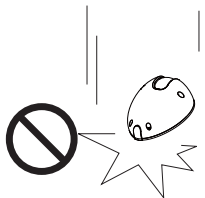

1

Package Contents

- MD7530 / MD7560 or MD7530D / MD7560D
(PoE) (With power cord)

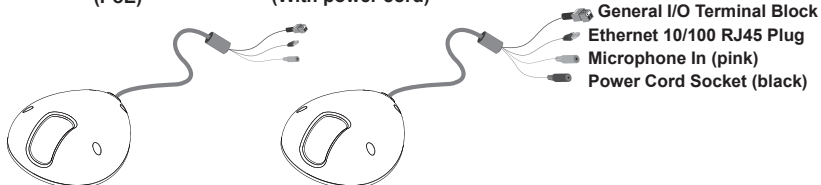

- Software CD



- Alignment Sticker

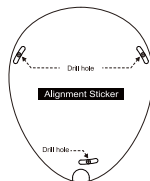

- Quick Installation Guide / Warranty Card



- Ground Wire / Screws

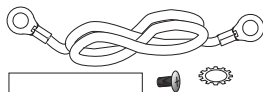

- Screwdriver

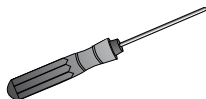

- Silica Gel / RJ45 Female/Female Coupler

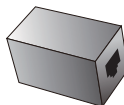

2 Physical Description

Inner View

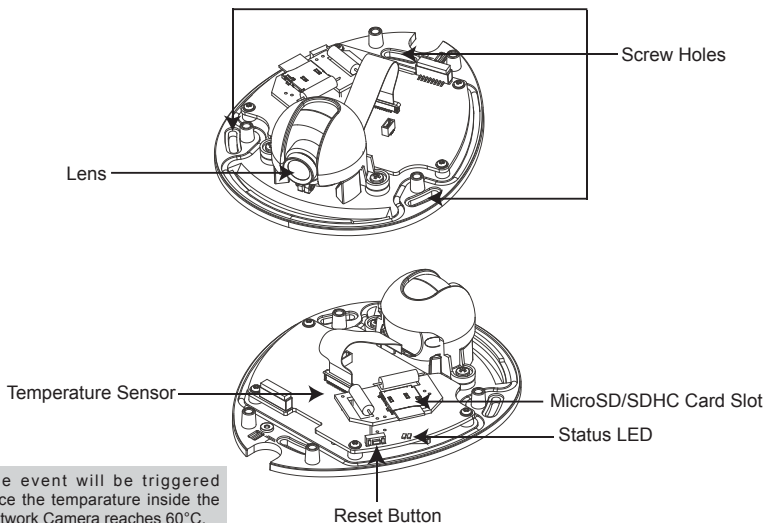

Outer View

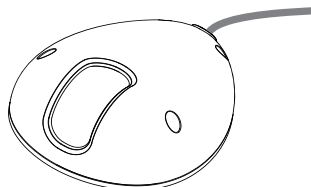

Waterproof Level: IP67

Record the MAC address before installing the camera.



First, use the supplied screwdriver to detach the dome cover from the camera base. Insert your MicroSD/SDHC Card if necessary.

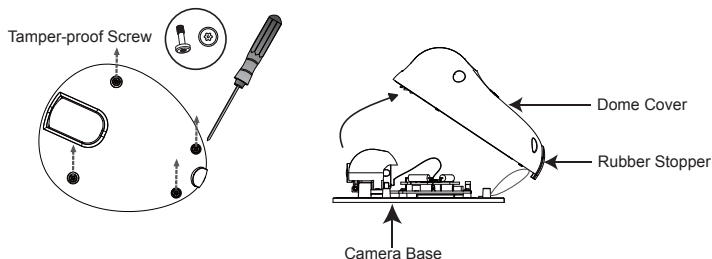

Then, follow the steps below to install the camera to either the ceiling or the wall:

1. Attach the supplied alignment sticker to the ceiling/wall.
2. Using the 3 screw circles on the sticker, drill 3 pilot holes into the ceiling/wall. Then hammer the plastic anchors into the holes if necessary.
3. This Network Camera can be mounted with the cable routed through the ceiling/wall or from the side. If you want to feed the cable through the ceiling/wall, drill a cable hole A as shown in the picture. If the cable goes through the side of the dome cover, please remove the rubber stopper (B).
4. Through the 3 holes on the camera base, insert the screws to corresponding holes and secure the camera base with a screwdriver.

Ceiling Mount

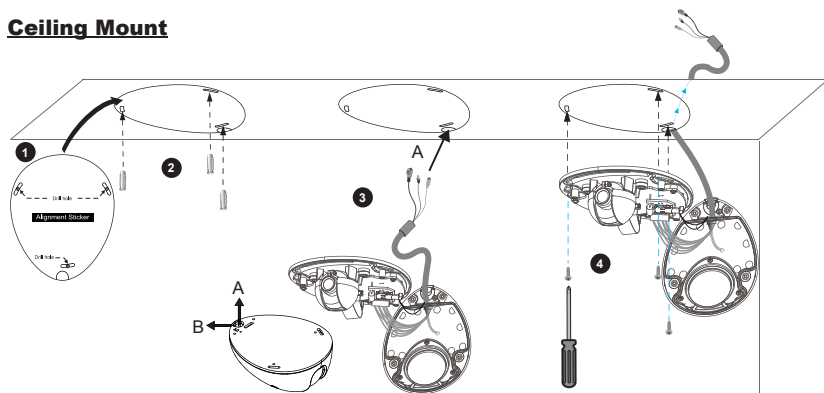

Wall Mount

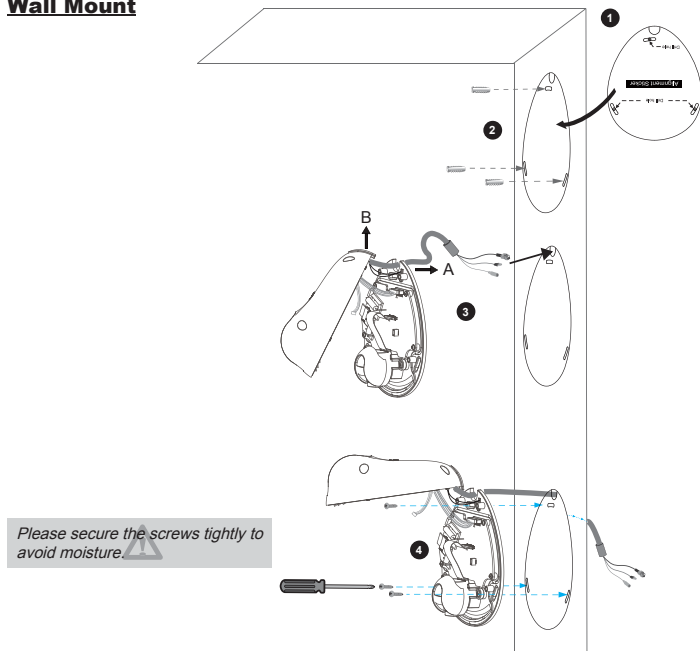

Installing the Ground Wire

As shown in the following figure, please secure one side of the supplied ground wire to the screw hole, then route the other side of the ground wire to the ground.

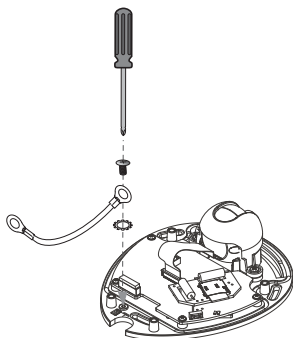

General Connection (without PoE) (MD7530D / MD7560D)

1. If you have external DI devices, make the connection from general I/O terminal block.
2. Use the supplied RJ45 female/female coupler to connect the Network Camera to a switch.
3. Connect the power cable from the Network Camera to a power outlet.

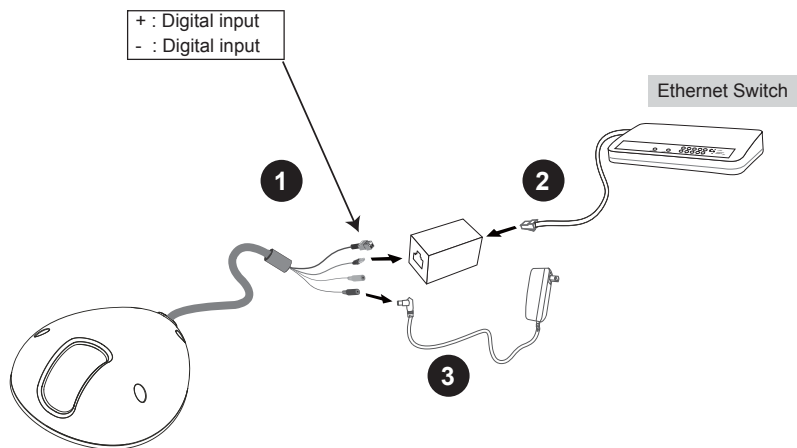

Power over Ethernet (PoE) (MD7530 / MD7560)

● When using a PoE-enabled switch

This Network Camera is PoE-compliant, allowing transmission of power and data via a single Ethernet cable. Follow the below illustration to connect the camera to a PoE-enabled switch via Ethernet cable.

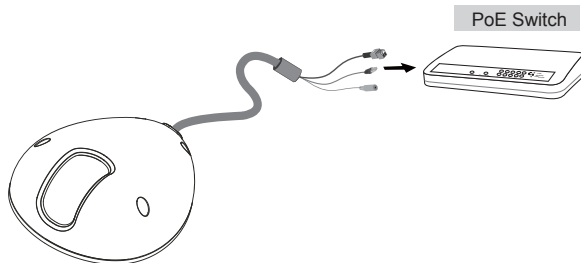

● When using a non-PoE switch

Use a PoE power injector (optional) to connect between the Network Camera and a non-PoE switch.

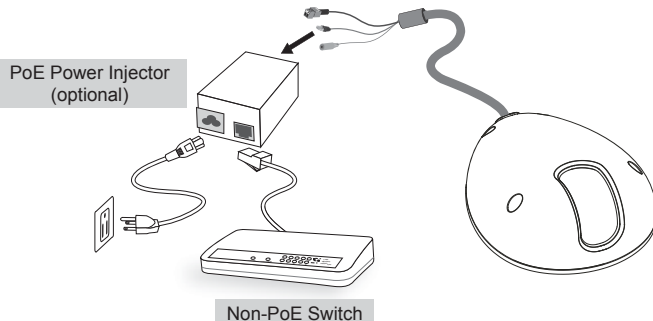

1. Install "Installation Wizard 2" from the Software Utility directory on the software CD.
2. The program will conduct an analysis of your network environment. After your network is analyzed, please click on the "Next" button to continue the program.



3. The program will search for VIVOTEK Video Receivers, Video Servers, and Network Cameras on the same LAN.
4. After searching, the main installer window will pop up. Click on the MAC that matches the one labeled on the bottom of your device to connect to the Network Camera via Internet Explorer.



6 Ready to Use

1. Access the Network Camera on the LAN.
2. Retrieve live video through a web browser or recording software.

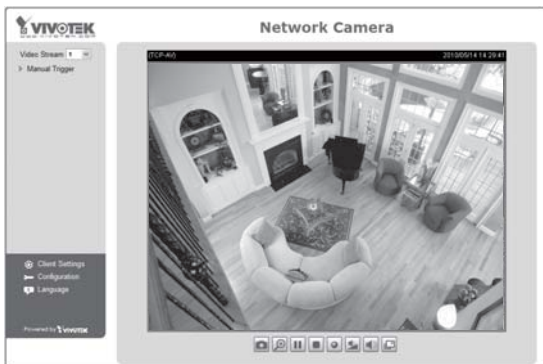

For further setup, please refer to the user's manual on the software CD.

7 Adjusting the Lens

To adjust the viewing angle

Adjust the lens to a desired viewing angle as the diagram shown below.

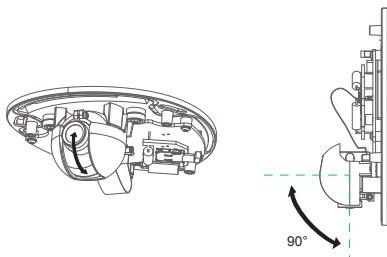

DO NOT over rotate the lens. Doing so will damage the camera lens module.

Fine-tune the Camera Focus

The focus of this network camera is set from 1.0m to infinity by factory default. If you want to focus on objects closer than 1.0m or the lens has lost focus, please fine tune it in the following way.

1. Loosen the lens lock screw.
2. Manually rotate the lens to fine-tune the focus until the live image is clear.
3. Tighten the lens lock screw.

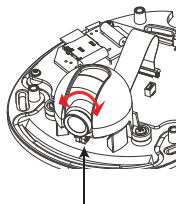

Tighten the lens lock screw.

8

Completion

Tear down the aluminum foil vacuum bag and take out the silica gel. Attach the supplied silica gel to the inner side of the Network Camera. (Please replace the silica gel with a new one if you open the back cover after installation.)

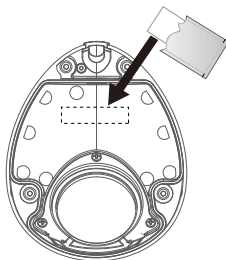

Attach the dome cover to camera. Secure the dome screws with the supplied screwdriver. Finally, make sure all parts of the camera are securely installed.

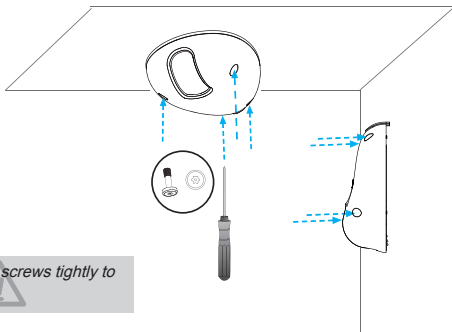

Please secure the screws tightly to avoid moisture.



P/N:625011800G Ver1.0
Copyright © 2010 VIVOTEK INC. All rights reserved.

6F, No.192, Lien-Cheng Rd., Chung-Ho, Taipei County, Taiwan | T: +886 2 82455282 | F: +886 2 82455532 | E: sales@vivotek.com